



**EVH series**

**EVH 12150 12V 15AH**



**Valve Regulated Lead Acid Battery**

Maintenance-Free Sealed Lead Acid Battery.  
Absorbent Glass Mat (AGM) technology for efficient gas recombination of up to 99%.

**Design for Cyclic Applications**

<p><b>【Design Life】</b> 450 cycles @ 100%DOD at 25°C 1800 cycles @ 30%DOD at 25°C</p> <p><b>【Operating Temperature Range】</b> Nominal Operating Temperature : 25°C (77°F) Discharge : -15°C ~ 50°C (5°F~122°F) Charge: -15°C ~ 40°C (5°F~104°F) Storage: -15°C ~ 40°C (5°F~104°F)</p>	<p><b>【Equalization Charging Voltage】</b> 14.4 ~ 15.0 VDC/Unit at 25°C (77°F)</p> <p><b>【Self Discharge】</b> Less than 10% after 90 days, can be stored up to 6 months at 25°C (77°F); Fully recharging is required before usage, and charged sooner if stored at higher temperature than 25°C (77°F).</p>
---	--

**Specification**

Nominal Voltage	12V (6 cells per unit)	
Nominal Capacity	15 Ah @20hr-rate to 1.75V per cell @25°C (77°F)	
Weight	Approx. 4.60 Kg (10.14 lbs)	
Maximum Discharge Current	180 A (5sec)	
Internal Resistance	Approx. 10.5 mΩ	
Short Circuit Current	--	
Maximum Charge Current	4.50 A	
Terminal type	F2 terminal -Faston Tab 250	
Terminal hardware Torque	--	
Container Material	ABS (UL 94-HB) & Flame Retardant (94-V0) available upon request	
Dimensions	Length (L)	151.0±2.0 mm      5.94±0.08 inch
	Width (W)	98.0±1.0 mm      3.86±0.04 inch
	Container Height (h)	97.5±1.0 mm      3.84±0.04 inch
	Overall Height (H)	101.8±1.5 mm      4.01±0.06 inch

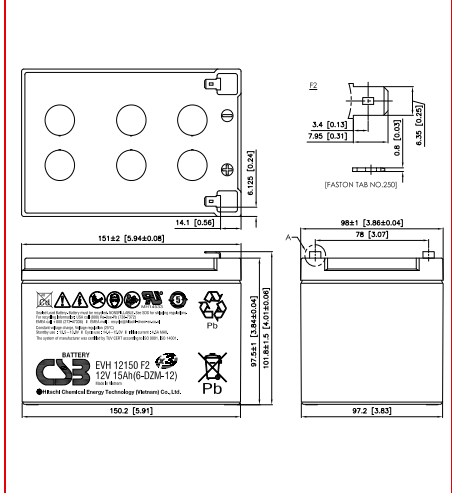

**Constant Current Discharge Characteristics Unit: A (25°C, 77°F)**

F.V/Time	30MIN	45MIN	60MIN	90MIN	2HR	3HR	4HR	5HR	6HR	8HR	10HR	20HR
1.60V	20.0	14.4	11.2	7.85	6.18	4.33	3.35	2.74	2.17	1.79	1.43	0.79
1.67V	19.9	14.1	11.0	7.79	6.11	4.25	3.31	2.73	2.16	1.78	1.42	0.78
1.70V	19.8	13.9	10.9	7.73	6.03	4.23	3.30	2.72	2.15	1.77	1.41	0.77
1.75V	19.5	13.8	10.8	7.66	6.00	4.17	3.27	2.71	2.14	1.76	1.39	0.76
1.80V	19.0	13.8	10.7	7.50	5.83	4.08	3.19	2.64	2.10	1.74	1.38	0.75
1.85V	18.2	13.3	10.4	7.38	5.72	3.94	3.09	2.56	2.03	1.68	1.33	0.72

**Constant Power Discharge Characteristics Unit: W (25°C, 77°F)**

F.V/Time	30MIN	45MIN	60MIN	90MIN	2HR	3HR	4HR	5HR	6HR	8HR	10HR	20HR
1.60V	221	165	129	91.4	71.0	49.6	38.9	31.9	25.3	21.0	17.1	8.98
1.67V	220	163	128	90.8	70.5	49.2	38.6	31.7	25.2	20.9	17.0	8.96
1.70V	218	162	127	89.9	70.0	49.0	38.4	31.5	25.1	20.8	16.9	8.92
1.75V	215	159	125	88.7	69.4	48.8	38.1	31.1	24.9	20.7	16.8	8.82
1.80V	211	157	123	87.3	68.6	47.9	37.5	30.7	24.6	20.5	16.7	8.74
1.85V	206	155	121	85.3	66.6	46.7	36.3	29.6	23.8	19.9	16.4	8.52

Please refer to the official site for the latest rating confirmation. URL: [www.csb-battery.com](http://www.csb-battery.com)

Issued: 170124

**Sales Offices**

日立化成能源科技股份有限公司  
Hitachi Chemical Energy Technology Co., Ltd.

**BUSINESS HEADQUARTERS**

Tel: +886-2-2880-5600  
Fax: +866-2-2888-3300

**USA OFFICE**

Tel: +1-817-244-7777 / 1-(800)3-CSB-USA (272872)  
Fax: +1-817-244-4445

**SHENZHEN OFFICE (CHINA)**

Tel: +86-755-8831-6488, 8831-6775  
Fax: +86-755-8831-6075

**EUROPE (EMEA) OFFICE**

Tel: +31(0)180-418-140  
Fax: +31(0)180-418-327

**SHANGHAI OFFICE (CHINA)**

Tel: +86-21-5046-1622, 5046-0833  
Fax: +86-21-5046-1046

**TAIPEI OFFICE**

Tel: +886-2-2880-5600  
Fax: +866-2-2888-3300

**BEIJING OFFICE (CHINA)**

Tel: +86-10-5820-5336, 5820-5338  
Fax: +86-10-5820-3053

Recognized under UL 1989,  
and certified by ISO 9001, 14001.

